

STEP 2. CHOOSE YOUR DOOR

HOLLOW METAL DOORS

The Madero retail door program includes 20 gauge hollow metal doors for commercial buildings, outbuildings and fire rated residential applications. LS series Galvanneal steel doors are available with two core options; honeycomb core for interior use, or insulated with polystyrene or polyurethane for exterior applications and sound transmission control.

20 GA. LOCKSEAM STEEL DOOR 1-3/4"

Lock seam and beveled edges mechanically interlocking seams on door edges only.

Closer Reinforcement: 14 ga. closer reinforcement, fitted to 16 ga. inverted top channel

Hinge Reinforcement: 7 ga. hinge reinforcement; to accept (3) 4-1/2" hinges

Lock Preparation: ANSI 161 lock reinforcement; 14 ga. prepared for 2-3/4" backset

Beveled to 1/8" or 2 degree bevel

Size Specifications: 6/8 reversible doors will accommodate inswing, outswing, left hand or right hand.

Nominal size

2/8 x 6/8
3/0 x 6/8

Actual size

31-3/4" x 79-1/8"
35-3/4" x 79-1/8"

2/8 x 7/0
3/0 x 7/0

31-3/4" x 83-1/8"
35-3/4" x 83-1/8"

NOTE: Special order available in 2/0 to 3/6 widths. 6/8 doors are reversible, 7/0 requires handing when order is placed.

Core Options:

Honeycomb core (HM)

- **Usages:** Interior, fire rated
- **Specs:** R Value 2.5, STC 32

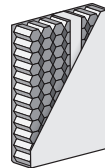

Polystyrene (HMIS)

- **Usages:** Exterior, sound
- **Specs:** R Value 6.6, STC 34

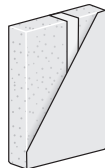

DAYBAR



Intertek

Honeycomb filled doors are fire rated to 90 minutes with a label attached.

PRIMER NOT REQUIRED

Galvanneal steel is matte grey and ready for the finish paint

WHI listed door glazing kits available. Contact your sales associate.

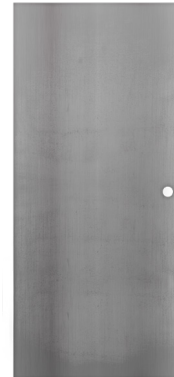

WHAT IS DAYBAR QUALITY?

Daybar quality is built on 50 years of manufacturing experience, broad fire and physical endurance certification capabilities and the best warranty program available in the industry.

Hinge Placement:

6/8 Template

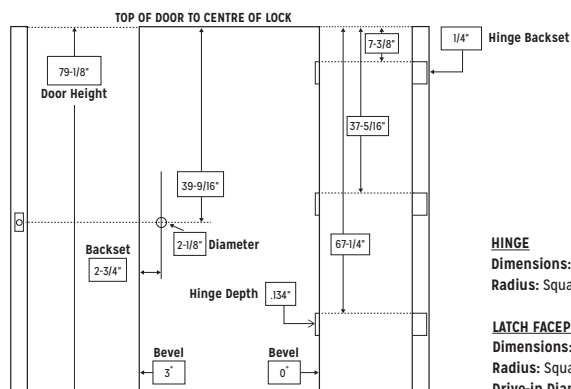

7/0 Template

